

INSTALLATION GUIDE

Version 3.2 Jan. 2013
Publication# L9786, ©Coverstar, LLC



ENCAPSULATION INSTRUCTIONS

For Fiberglass Pools and Pool in Pool

Pool builders prefer the encapsulation system over other methods because it makes for an easier installation, much more design flexibility and lower maintenance for the pool owner. Instead of drilling holes and attaching the cover guide under a cantilevered deck when the pool is full, a special extrusion which encapsulates the cover guide is attached to the top of the pool wall and the deck is formed around it for a “built-in”, almost invisible look. The guides can also be removed from the encapsulation for service by removing the encapsulation spacer.

The encapsulation kit for Fiberglass Pools includes encapsulation for both sides of the pool and the end wall (individual parts shown below). These kits can be used with the reusable coping forming kits, clip on rounded coping, or a brick or stone coping.

Encapsulation Kits for Fiberglass Pools

A2848 - 16' x 32'

A2866 - 16' x 40'

Tools Required

- Saw
- Hammer drill w/ 1/4" masonry bit.
- Cordless drill w/ #3 phillips bit.

	Part #	Description
1.	X0953	Encapsulation 403 Fiberglass Pool 21 ft.
2.	A1721	60 pk #12 X 1 inch HHW Tek Screws
3.	A2891	10 pk Screw HHW tek #12 X 1 inch SS
4.	X0093	Spacer for Encapsulated Guide
5.	X0125	Encapsulation Metal Filler

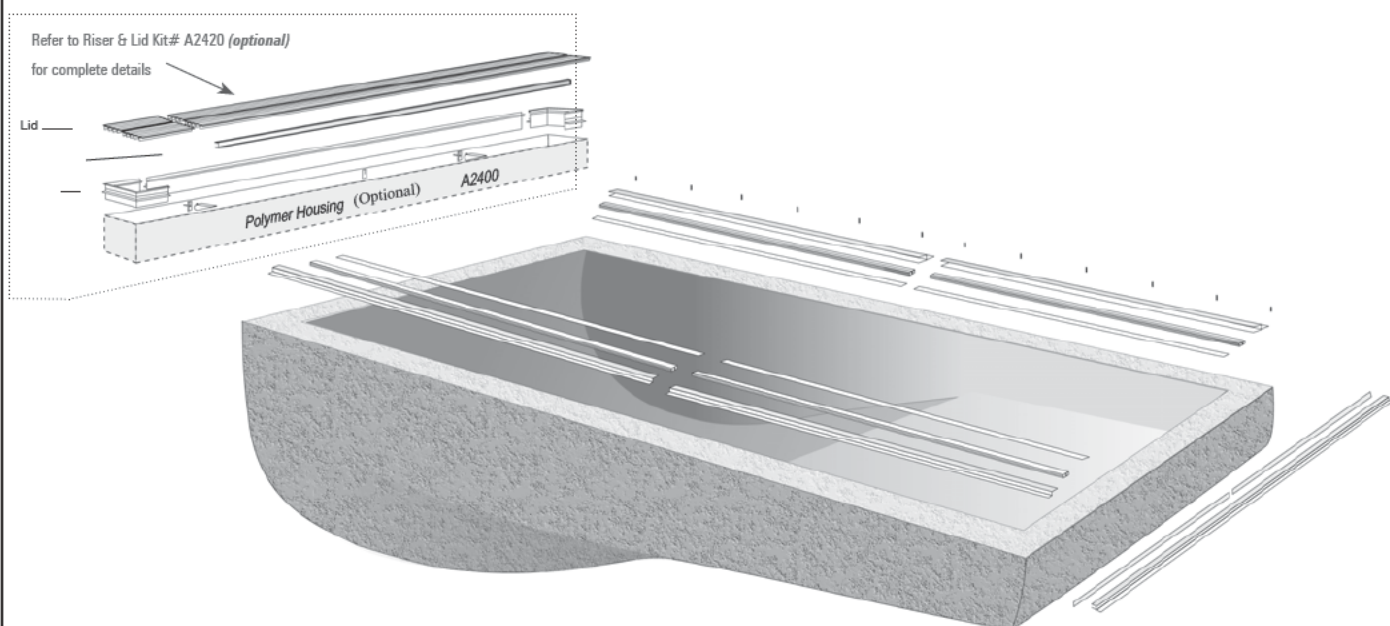



Square The Pool

Run string lines around the pool to create a perfectly rectangular pool. Measure widths, lengths and diagonals before securing the encapsulation to the pool wall.



Begin in the Corners

Use a mitre saw to cut two lengths of encapsulation on a 45 degree angle. Bring the cut ends together for form a 90 degree corner. Secure the encapsulation to the pool using the screws provided.

Tip: Install track and spacer in the encapsulation to help the encapsulation and corners line up straight while it is being secured to the pool wall.



Place The Encapsulation

Continue installing the encapsulation around the perimeter of the pool. At the mechanism end, extend the encapsulation 1 inch past the inside edge of the cover housing.



Metal Filler

The metal filler piece is used to cover the track channel in the encapsulation at the shallow end of the pool. After measuring and cutting the metal filler to the correct length, use a rubber mallet to tap them into position.

Reusable Coping Forms

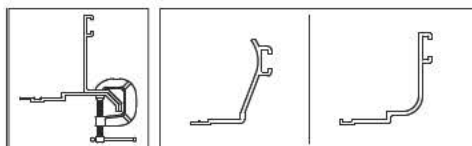

Cantilever 2 pc.

Inclined 1 pc.

Cantilever 1 pc.

Easy to use, one or two piece reusable forms are inserted into the encapsulation and held in place with a temporary spacer. After the deck is formed and cured, the spacers and the forms can be removed and cleaned for the next use.

Clip-on Coping

Compatible with Standard Vinyl Liner and Fiberglass Encapsulation. Permanent clip-on coping available in a rounded shape.



Pool-in-Pool Encapsulation Kits - For All Types Of Non-Rectangular Pools

The Pool-in-Pool cover guide encapsulation kits allow builders to cover almost any freeform pool with an automatic cover. The basic idea behind the Pool-in-pool concept is to create a rectangular step down area around the freeform shape of the pool. The step can be formed using either clip-on coping, reusable forms or brick coping. Standard size kits are listed below.

Pool-in-Pool Encapsulation Kits

A1681 - 20" x 40"

A1964 - 22" x 50"

Installation Steps

1. Pour the lower deck area around the pool first and let it cure. The rectangular perimeter of the lower deck (A, deck step diagram) should be completely level and flat for mounting the Pool-in-Pool cover guide encapsulation. The deck from the inside of the perimeter (B) should slope slightly toward the pool for water runoff. Large areas of deck in the lower deck area should have a drain.
2. Place the Pool-in-Pool encapsulation on the level and flat deck perimeter. Be sure that diagonals, width and length measurements are equal and square to each other.
3. Fasten the encapsulation to the decking using the mounting screws and anchors.
4. Insert clip-on coping or reusable deck forms into the encapsulation.
5. Pour the outer concrete step (C).

Standard Pool-in-Pool Encapsulation Kit (A1773)

The standard Pool-in-Pool encapsulation kit for pools up to 20' x 40' includes the parts list below.

Part #	Description
1. X0705	Encapsulation UG 403, 21 ft.
2. A1707	PPSM #12 x 1 3/4" Screw
3. A1705	Anchor #12 Concrete STD
4. X0093	Encapsulation Spacer 801, 403 light grey 21ft. EA
5. X0125	Encapsulation Metal Filler, 10 ft. EA



Deck Step Diagram

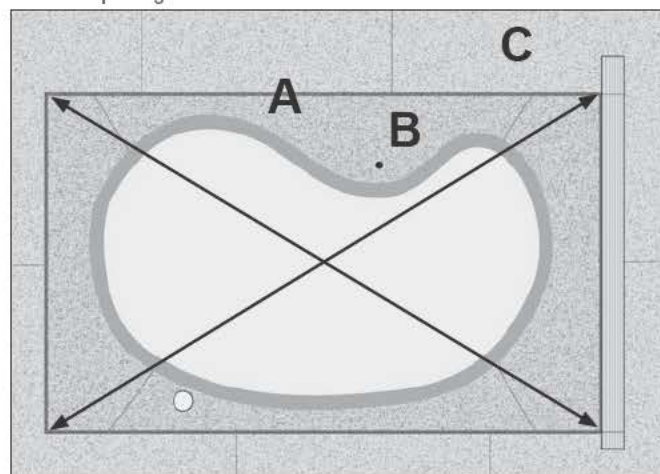

Standard Pool-in-Pool Encapsulation Kit

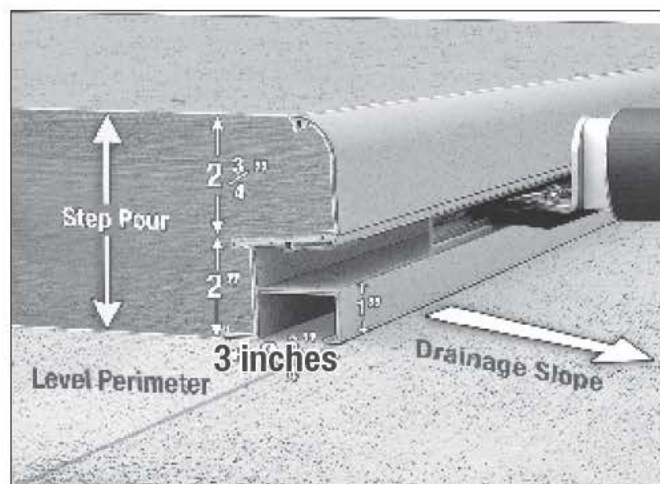

(Optional Rounded Clip-on Coping Shown)

QUESTIONS?

For questions about this installation guide,
contact your independent distributor.

INSTALLATION GUIDE

Version 3.2 Jan. 2013

Publication# LL9643, ©Coverstar, LLC

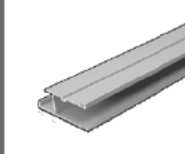

ENCAPSULATION INSTRUCTIONS

For Gunite Pools

Pool builders prefer the encapsulation system over other methods because it makes for an easier installation, much more design flexibility and lower maintenance for the pool owner. Instead of drilling holes and attaching the cover guide under a cantilevered deck when the pool is full, a special extrusion which encapsulates the cover guide is attached to the top of the pool wall and the deck is formed around it for a "built-in", almost invisible look. The guides can also be removed from the encapsulation for service by removing the encapsulation spacer.

The gunite encapsulation kit includes encapsulation for both sides of the pool and the end wall (individual parts shown below). This kit should be used if you are forming your decking with a deck forming system.

Gunite Encapsulation Kits

A2845 - 10" x 20"

A1210 - 16" x 32"

A1217 - 18" x 36"

A1224 - 20" x 40"

A1261 - 22" x 50"

	Part #	Description
1.	X0651	Encapsulation UG 403, 21 ft.
2.	A1729	Encapsulation Hardware kit
3.	X0796	Spacer for gunite encapsulation
4.	X0125	Encapsulation Metal Filler, 10 ft.
5.	L9786	Encapsulation installation guide

Tools Required

- Saw
- Hammer drill w/ 1/4" masonry bit.
- Cordless drill w/ #3 phillips bit.

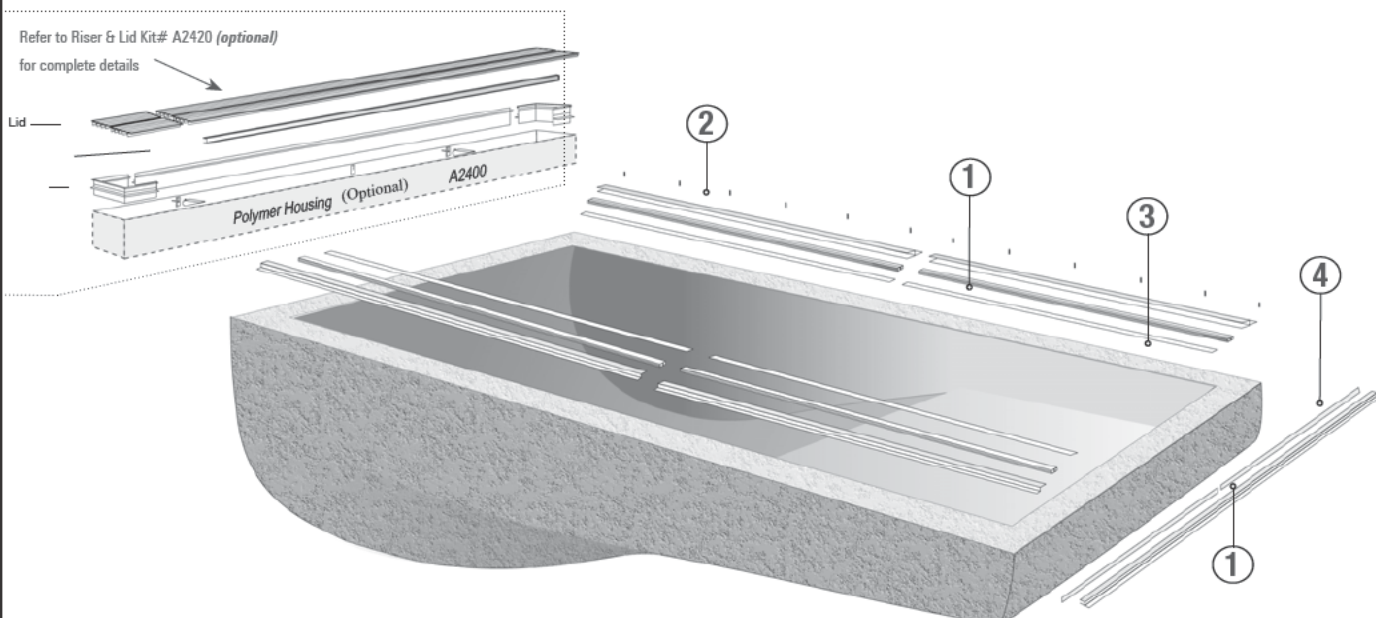

Gunite Encapsulation Placement Options & Deck Forming Options

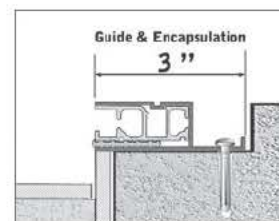
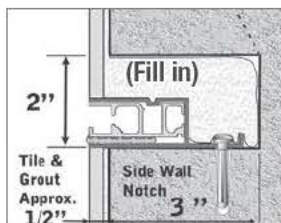
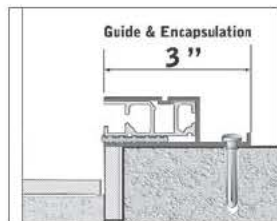
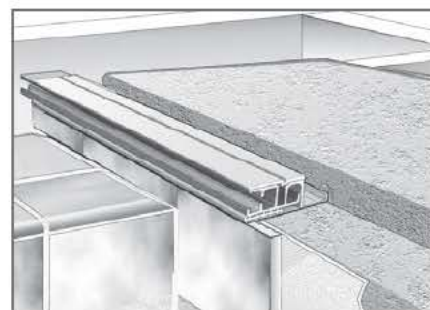
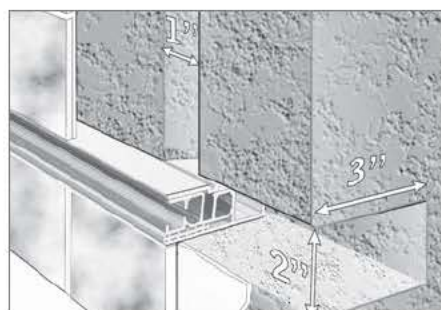
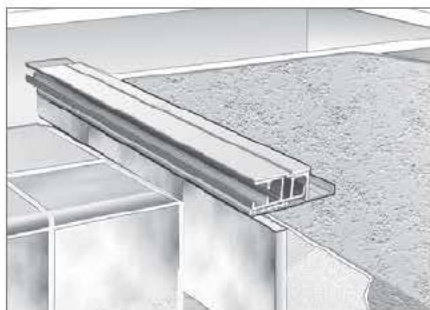

Typical Guide Placement

The typical and preferred placement for the gunite encapsulation is to set the encapsulation after tile or extending 1/2" beyond the gunite side wall. The side and end walls are the same elevation. End wall tile next to the cover guide encapsulation (see above) is bevel cut to allow the cover and slider to operate properly. Since the end wall is not lowered in this option, the wall construction is easier and the cover housing accumulates less water when the pool is in use. When possible, it is suggested that you set tile and level the 3" surface behind it before mounting the encapsulation.

Raised Walls

With the gunite encapsulation system no cantilever is required on the raised wall. Form a level notch in the raised bond beam for the encapsulation 3" deep and 2" high. This notch should be at the same elevation as the bottom of the encapsulation or standard track on the other side of the pool. Make a pocket hole 3" wide and approximately 12" high every 24" to 30" (see above) for the anchor and screws that attach the encapsulation to the pool wall. After the encapsulation is fastened to the pool wall, fill pocket holes with grout.

Inset Guide Option

Although the typical placement of the encapsulation is on top of the bond beam, some builders prefer to lower the encapsulation so that it is flush with the top of the bond beam. In these instances, a 1" x 3" notch is formed on the inside edge of the bond beam. The bond beam at the cover housing end of the pool must be lowered 2" (before tile).

Regardless of the encapsulation mounting method that is used, it is recommended that the track and spacer be inserted into the encapsulation to prevent it from collapsing while the coping is poured. Coverstar offers an optional protector piece (X0765) that can be inserted into the track to keep the track clean during the plastering of the pool.

Coping Options

Reusable Coping Forms

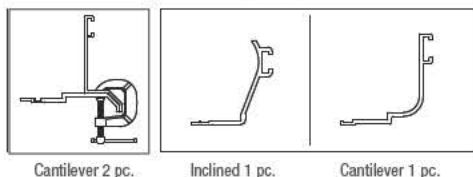

Easy to use, one or two piece reusable forms are inserted into the encapsulation and held in place with a temporary spacer. After the deck is formed and cured, the spacers and the forms can be removed and cleaned for the next use.

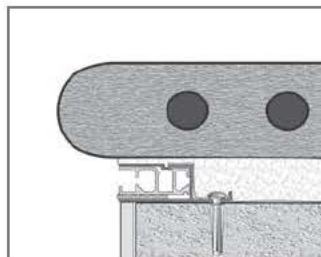

Brick & Stone Decking

The cover guide encapsulation system works well with any brick or stone coping. Be sure to apply tape over the open face of the guide encapsulation to block out debris and mortar during construction or use guide protection cap, (Part# X0765). Strip away tape or the protection cap after coping and tile have been set. When using brick or stone coping, they should not cantilever more than 1 inch past the encapsulation.

Step By Step Instructions - Gunite Pool Cover Guide Encapsulation



Mortar A Level Mounting Bed

Mortar the top of the gunite walls so they have a 3" min flat, straight and level surface for the encapsulation to be mounted to.



Square The Pool

It is recommended that the encapsulation be secured to the pool wall after the tile has been installed. If the encapsulation will be installed before tile, run string lines around the pool to create a perfectly rectangular pool.



Place The Encapsulation

If encapsulation is installed before the tile, overhang the encapsulation 1/2" into the pool aligned with the string line. If the tile has already been installed, place the encapsulation flush with the tile.



Mitre The Corners

Begin at the end of the pool opposite the cover mechanism. Mitre cut a 45 degree angle on the ends of two lengths of encapsulation. Place them together on the corner to form a 90 degree corner.

Make the same cuts for the other corner of the pool. Continue placing lengths of encapsulation around the rest of the pool. Cut the encapsulation so it will extend 1 inch into the cover housing.



Drill Holes In The Wall

Drill through the back flange of the encapsulation 2 1/2" deep. These holes should be placed every 24 - 30 inches.



Tap In Anchors

Move the encapsulation back a few inches to expose holes. Insert plastic anchors into each hole.

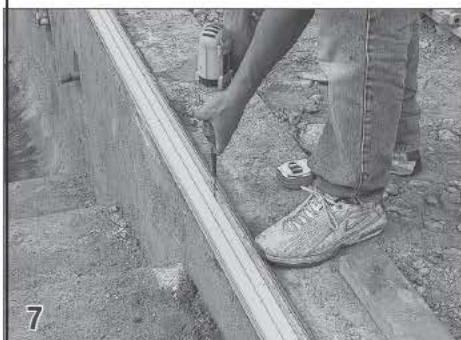

Fasten Encapsulation In Place

Place the encapsulation back over the holes and anchors. Secure the encapsulation to the pool walls by inserting a hex head screw and tightening with a drill.

Tip: Install track and spacer in the encapsulation to help the encapsulation and corners line up straight while it is being secured to the pool wall.

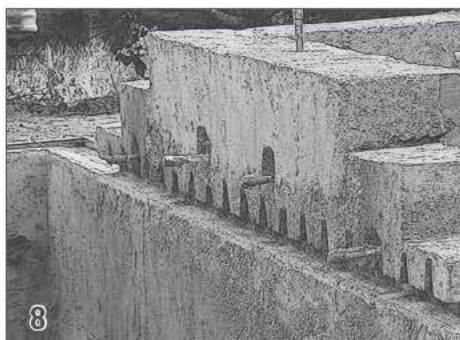

Optional Raised Wall with Pocket Holes

Pools with a raised wall need a cavity large enough to accept the encapsulation (3"x 2") and should have pocket holes formed to allow it to be screwed into place.



Optional Raised Wall

Pools with raised walls can also be formed with a three inch ledge. The encapsulation is anchored to the ledge, allowing stone to be set in place on top of the encapsulation. It is important that the track and spacer be inserted into the encapsulation to prevent it from collapsing.

QUESTIONS?

For questions about this installation guide,
contact your independent distributor.

INSTALLATION GUIDE

Version 3.3 Apr. 2016
Publication# L9641, ©Coverstar, LLC

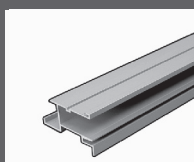

ENCAPSULATION INSTRUCTIONS

Standard Vinyl Liner

One Piece Vinyl Liner Encapsulation

Pool builders prefer the encapsulation system over other methods because it makes for an easier installation, much more design flexibility and lower maintenance for the pool owner. Instead of drilling holes and attaching the cover track under a cantilevered deck when the pool is full, a special extrusion which encapsulates the cover track is attached to the top of the pool wall and the deck is formed around it for a "built-in", almost invisible look. The track can also be removed from the encapsulation for service by removing the encapsulation spacer.

The encapsulation kit for Vinyl Liner Pools includes encapsulation for both sides of the pool and the end wall (individual parts shown below). These kits can be used with the reusable coping forming kits or clip on rounded

	Part #	Description
1.	X0650	Encapsulation 403 vinyl liner 21 ft.
2.	X0945	Wall Cap 309 with VL 20 ft 1 inch
3.	X0091	Spacer for encapsulated guide 404, 801 light grey 21 ft long EA
4.	X0125	Encapsulation filler metal 10 ft. for 403 or 801 encapsulation
5.	A1721	60 pk - Screw HHW tek #10 x 1 in zinc
6.	A2891	10 pk Screw HHW tek #12 SS (for wall cap)

The Standard system parts are shown below.	
 X0650	 X0945
 X0091	 X0125
 A1721	 A2891

Tools Required

- Mitre Saw
- Hammer drill w/ 1/4" masonry bit.
- Cordless drill w/ #3 phillips bit.

Standard Vinyl Liner Encapsulation Kits

A1213 - 16" x 32"
A1220 - 18" x 36"
A1227 - 20" x 40"
A1264 - 22" x 50"

Reusable Coping Forms

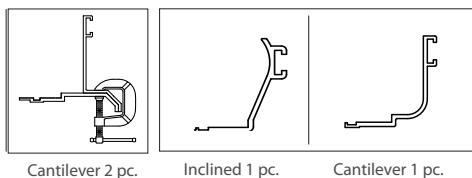

Easy to use, one or two piece reusable forms are inserted into the encapsulation and held in place with a temporary spacer. After the deck is formed and cured, the spacers and the forms can be removed and cleaned for the next use.





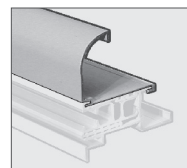

Clip-on Coping



Compatible with Standard Vinyl Liner and Fiberglass Encapsulation. Permanent clip-on coping available in a rounded shape.

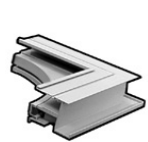

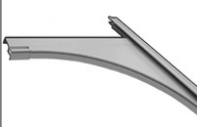
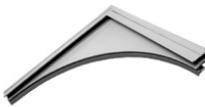
Standard Corner Options

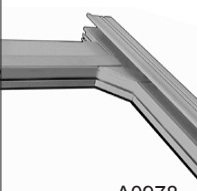
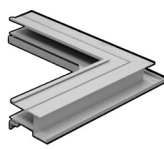
The Vinyl Liner Encapsulation System has four different corner options. You can simply miter cut the standard guide encapsulation that comes with the cover system for a 90 degree square corner, or choose from the three other pre-made corner options - 3"chopped, 6" radius or 2' radius corners.

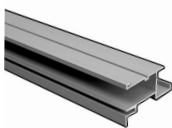
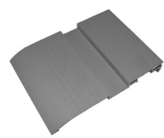
Mechanism End		Non-mech End	
A	B	C	
 A0971	 A0972	 A0973	6" Radius
 A0974	 A0975	 A0976	2' Radius
 A0977	 A0978	 A0979	3" Chopped

 X0650	 X0945
 X0091	

Installation Steps

1. Position corners (A,B,C) on pool
2. Cut straight lengths (1) to fill between
3. Metal filler (4) covers the screw down channel
4. Metal filler (4) finishes end encapsula-

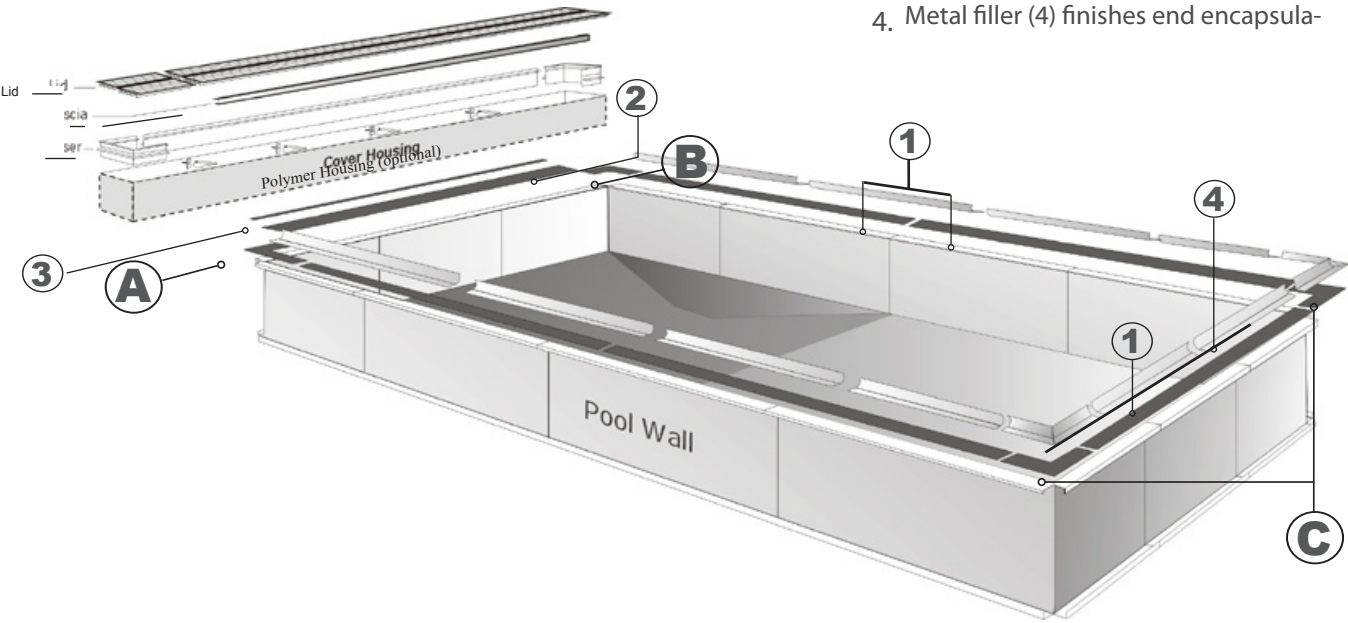



1

Install Encapsulation/Corners

When installing encapsulation on a vinyl liner pool, begin in the corners. If the pool includes 90 degree corners, mitre cut two lengths of encapsulation on a 45 degree angle. Bring the two lengths together to create the 90 degree corner. When using 90 degree corners, you must use liner lock to secure the liner to the encapsulation.

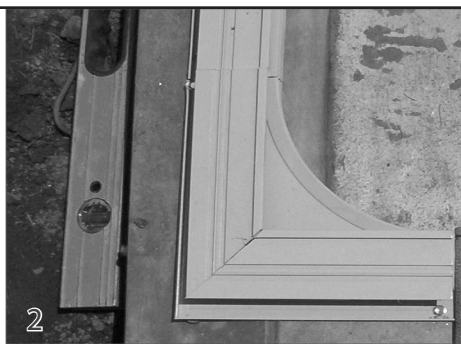

2

Installing Radius Corners

If the pool includes radius corners, attach the premade radius corners to the pool wall using 1 inch tek screws.

Tip: Install track and spacer in the encapsulation to help the encapsulation and corners line up straight while it is being secured to the pool wall.



3

Place Corners at the Mechanism End

Place the radius corners in their position over the corner at the mechanism end of the pool. Secure the corners to the wall using 1 inch tek screws.



4

Place The Encapsulation

Measure between the radius corners and cut a length of encapsulation to fill in between the corners on the shallow end of the pool.



5

Install a length of encapsulation from the corner along the side of the pool. Secure it to the pool wall using 1 inch tek screws.

Be sure to check the guide space, guide length and diagonal measurements to be sure the encapsulation is square.



6

Continue measuring and cutting the encapsulation to fill in all around the pool.



7

Install Wall Cap

Measure for the length of the wall cap. Use a mitre saw to cut it to the correct length. Use the 1 inch SS tek screws provided to secure it to the pool wall.



8

Install Metal Filler in Wall Cap

The metal filler pieces, which are 10 ft long, will snap into place to cover the screw channel in the wall cap. After measuring and cutting the metal filler to the correct length, use a rubber mallet to tap them into position.



9

Install Metal Filler in Encapsulation

The same metal filler piece that is used to cover the screw channel on the wall cap is also used to cover the track channel in the encapsulation at the shallow end of the pool. After measuring and cutting the metal filler to the correct length, use a rubber mallet to tap them into position.

One Piece Vinyl Liner Encapsulation

One Piece Encapsulation kits are available with a Rounded, Inclined or Bullnose coping shapes. Pre-made corner pieces are required when using this encapsulation.

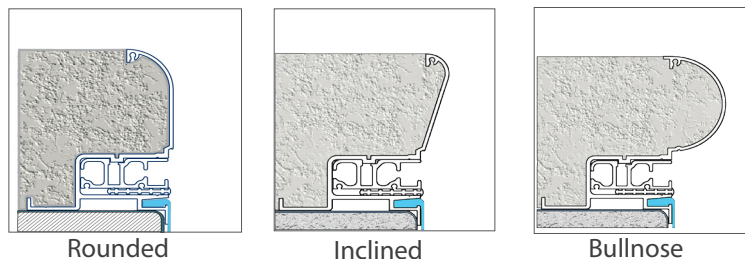

Corner Options

The One Piece Vinyl Liner Encapsulation System has four different corner options: 90 degree, 3"chopped, 6" radius or 2' radius corners. When using 90 degree corners, you will need to use liner lock to lock the liner bead into the bead receiver.

One Piece Encapsulation Kits

The encapsulation that is included in the one piece encapsulation kits are cut into different lengths according to the information below.

16 x 32	18 x 36	20 x 40	22 x 50
(2) 16 ft 2 in	(5) 12 ft 2 in	(1) 12 ft 2 in	(7) 6 ft 2 in
(3) 12 ft 2 in		(5) 16 ft 2 in	

Because the encapsulation comes in different lengths in some of the kits, it is important to lay them out around the pool before actually securing them to the pool. Doing this will allow the encapsulation to be positioned correctly on the pool walls so the joints between the lengths of encapsulation will be lined up from one side of the pool to the other. This will also make sure the appropriate length of encapsulation is used along the shallow end of the pool.

Tools Required

- Mitre Saw
- Hammer drill w/ 1/4"masonry bit.
- Cordless drill w/ #3 phillips bit.

Installation Steps

1. Position corners on pool walls
2. Cut straight lengths to fill between
3. Metal filler covers the screw down channel in
4. Metal filler finishes end encapsulation

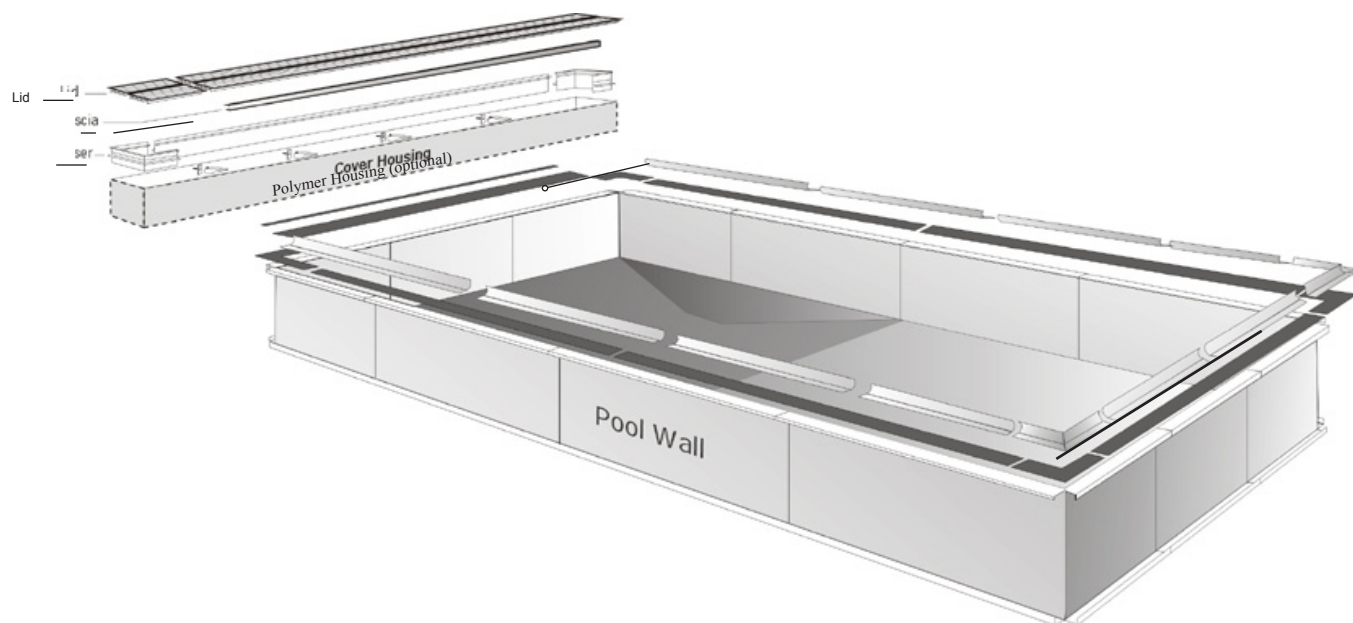



1

Place Corners at the Shallow End

When installing one piece encapsulation on a vinyl liner pool, begin in the corners. Attach the pre-made radius corners to the pool wall using 1 inch tek screws.

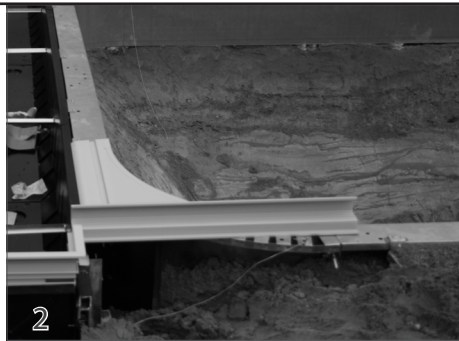

2

Place Corners at the Mechanism End

Place the radius corners in their position over the corner at the mechanism end of the pool. Secure the corners to the wall using 1 inch tek screws. Cut the encapsulation on the radius corner so it will extend 1 inch into the cover housing.



3

Install the Encapsulation

Measure between the radius corners and cut a length of encapsulation to fill in between the corners on the shallow end of the pool.



4

Install a length of encapsulation along the side of the pool. Secure it to the pool wall using 1 inch tek screws.

Be sure to check the guide space, guide length and diagonal measurements to be sure the encapsulation is square.



5

Continue measuring and cutting the encapsulation to fill in all around the pool.



6

Install Wall Cap

Measure for the length of the wall cap. Use a mitre saw to cut it to the correct length. Use the 1 inch SS tek screws provided to secure it to the wall.



7

Install Metal Filler in Wall Cap

The metal filler pieces, which come in 10 ft lengths, will snap into place to cover the screw channel in the wall cap. After measuring and cutting the metal filler to the correct length, use a rubber mallet to tap them into position.



8

Install Metal Filler in Encapsulation

The same metal filler piece that is used to cover the screw channel on the wall cap is also used to cover the track channel in the encapsulation at the shallow end of the pool. After measuring and cutting the metal filler to the correct length, use a rubber mallet to tap them into position.



9

Install Coping Clips

Install coping clips over the splices in the encapsulation. To install the coping clip, hook them on the bottom of the coping profile, then press it into place on the coping face. The coping clip will lock into a groove along the bottom of the coping and wrap around the top edge of the coping.

QUESTIONS?

For questions about this installation guide,
contact your independent distributor.